



WE CONNECT SPORT WITH ENGINEERING

3D Scanning tutorial

Content

0. Foreword.....	2
1. How to create a 3D model of your face using photogrammetry	2
2. Data Protection Notice	9

0. Foreword

This facial scan is required either to assess the fit of a standard-size mask or to create a fully customized, made-to-measure mask. The data collected is used solely for product design and fitting purposes. All scans are conducted in compliance with applicable data protection regulations, including GDPR.

1. How to create a 3D model of your face using photogrammetry

You can easily create this at home without a professional scanner – all you need is a smartphone and the **free Polycam app** for iOS/Android!

[Download the app for iOS](#)

[Download the app for Android](#)

1. As the app uses the smartphone's rear camera = assistance needed
2. Stand close to a wall (preferably white)
3. Natural daylight from the front of the face is ideal to avoid shadows.
 - **If shadows occur within the face, it might lead to deformed 3D model with false dimensions!**
4. Keep your head and face still, you can close your eyes.
5. Do not wear glasses, hats, or any other objects.
6. **Thick or long beard to be trimmed. Polycam would create the mesh of beard.**
7. **With long hair or bangs, tie or pull the hair back so the face is fully visible from chin to forehead. Additionally, wax or clay could be used.**
8. **Set up the measurements units in settings to millimeters.**
9. The app will take photos while your assistant slowly moves around your head with the smartphone, capturing all angles and distances.
 - Taking close-up shots is must, up to the camera can capture them sharply.
10. For best accuracy, we recommend at least 150 shots.
11. **Pay attention to capture both ends of your head, left and right.**
12. **Measure the 4 references in POLYCAM and double-check with real measurements so you can confirm the scan is precise.**
13. Additionally, we will need these 4 manual measurements from you to see and understand how you did the measuring to validate the 3D model.



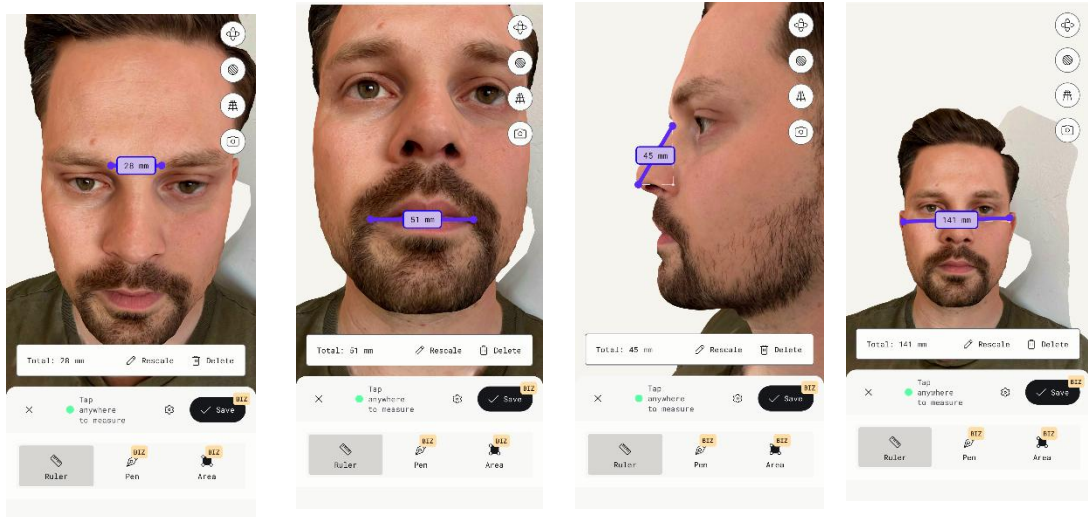

HOW TO MEASURE THE HEAD WIDTH

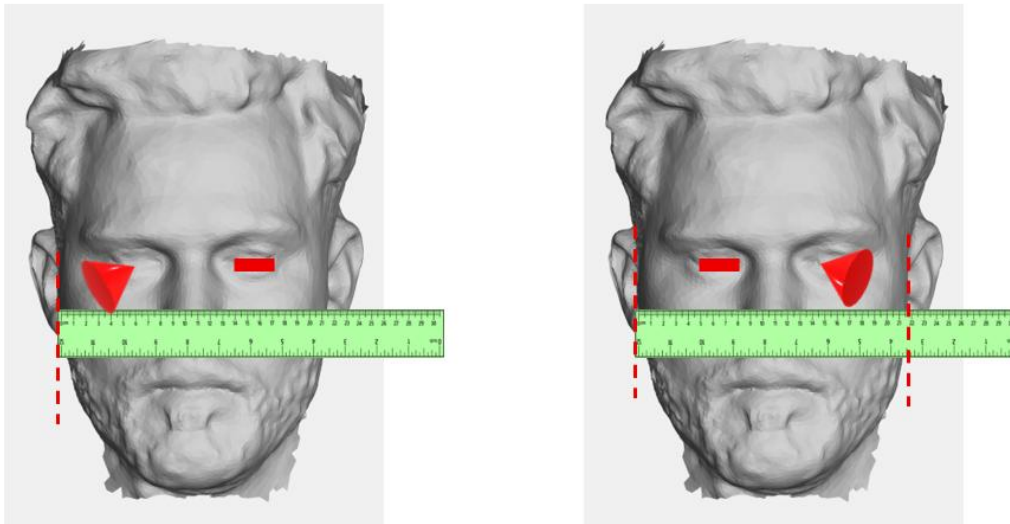

1. Stand in front of the mirror with the ruler.
2. Close your right eye and align the ruler at 0 with the left end of your head.
3. DO not move the ruler, close your left eye.
4. Measure your head width/breath by checking with your right eye on the ruler.



Pay attention to accurate captures with high quality.



Also, focus on scanning your left and right head ends. It is very important for a proper 3D model.

Step-by-step scanning guide:

- Download and install the app from the App Store / Google Play.
- Open the app on your smartphone and create an account (for example, via Google).

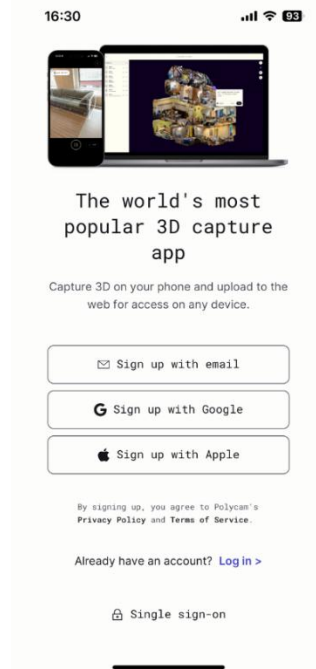

1. Set the units of measurements in settings to millimeters.

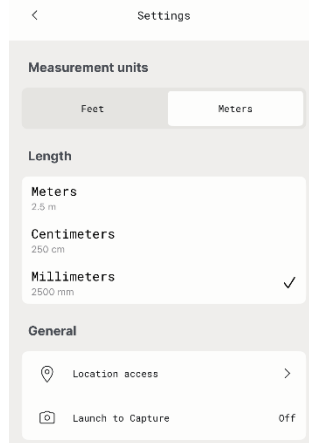

2. In the bottom section of the app, tap the "+" button and select the "Object" scan type.

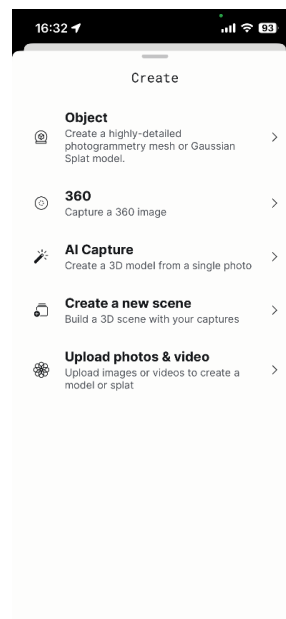
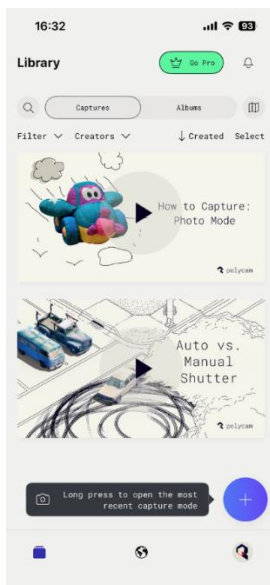

3. The app will probably request for subscription with 1 week free trial. **Do not forget to cancel the subscription once the scanning is completed.**
4. **If you would like to avoid this step, choose the option „Upload photos & video“ as seen in the picture above and select the photos captured manually before from your library. It is mandatory to import at least 150 detailed photos.**
5. The app will take photos while your assistant slowly moves around your head with the smartphone, capturing all angles and distances.

- a. We recommend taking detailed close-ups if your camera can capture them sharply.
- b. Capture at least 150 shots.
- c. Tap DONE to finish.

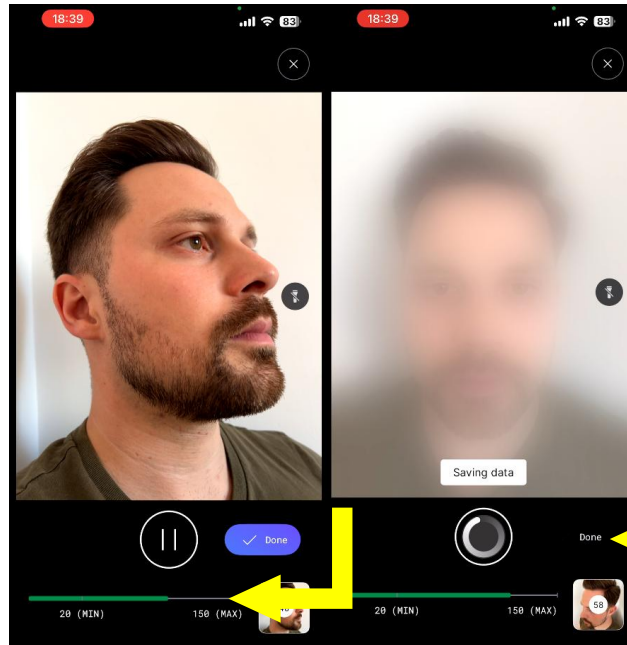

6. The scanning process will end and the photos will be uploaded. Upload time depends on your internet speed. You will see the upload status and completion.

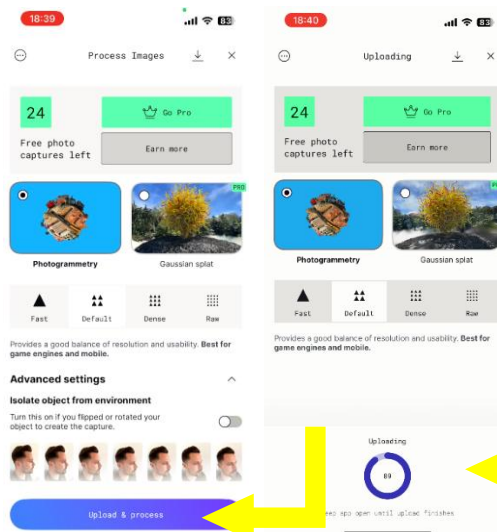

a. You can exit the process by tapping the cross (X).

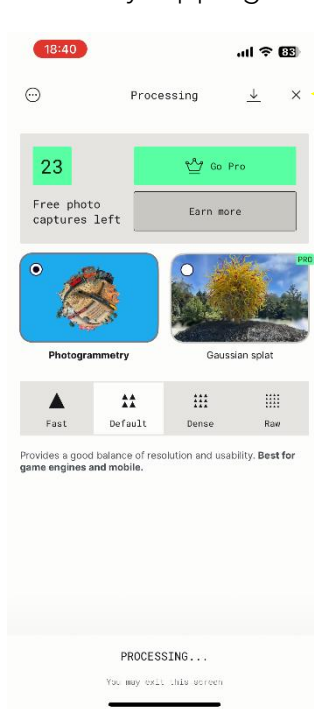

7. The 3D model will be generated in the app and you will be notified once it is ready.

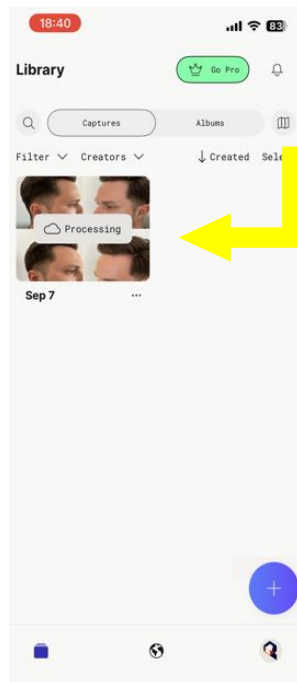

8. Viewing the model:
 - a. In the right-hand menu, you can change the mesh display style and other options.
 - b. Use zoom and gestures to move and rotate the model.

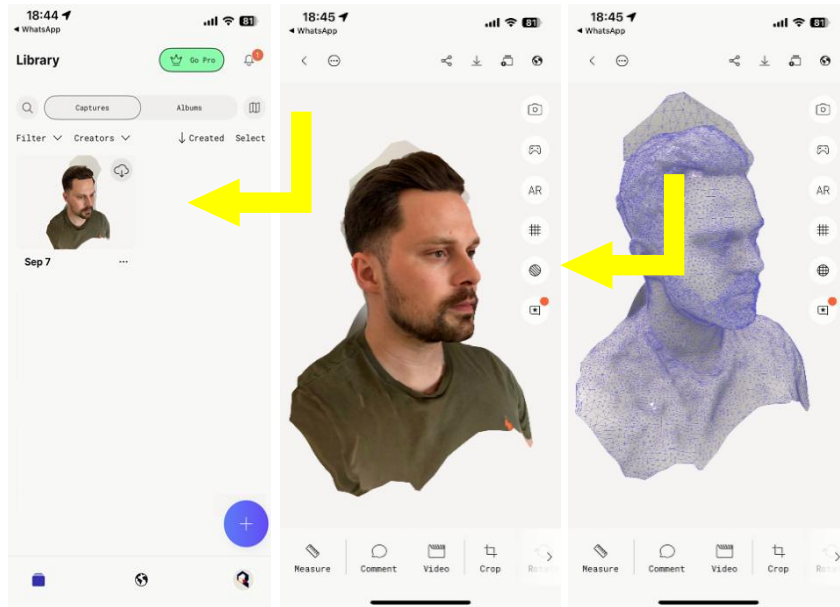

9. Export the model with texture and send it to info@compoacc.com
10. Capture such measurements and send it to info@compoacc.com
 - a. These captures are mandatory to validate the scan precision. You can use the transparent ruler.
 - b. Share with us also your head width.
 - c. Double-check your real measurements comply with 3D scan

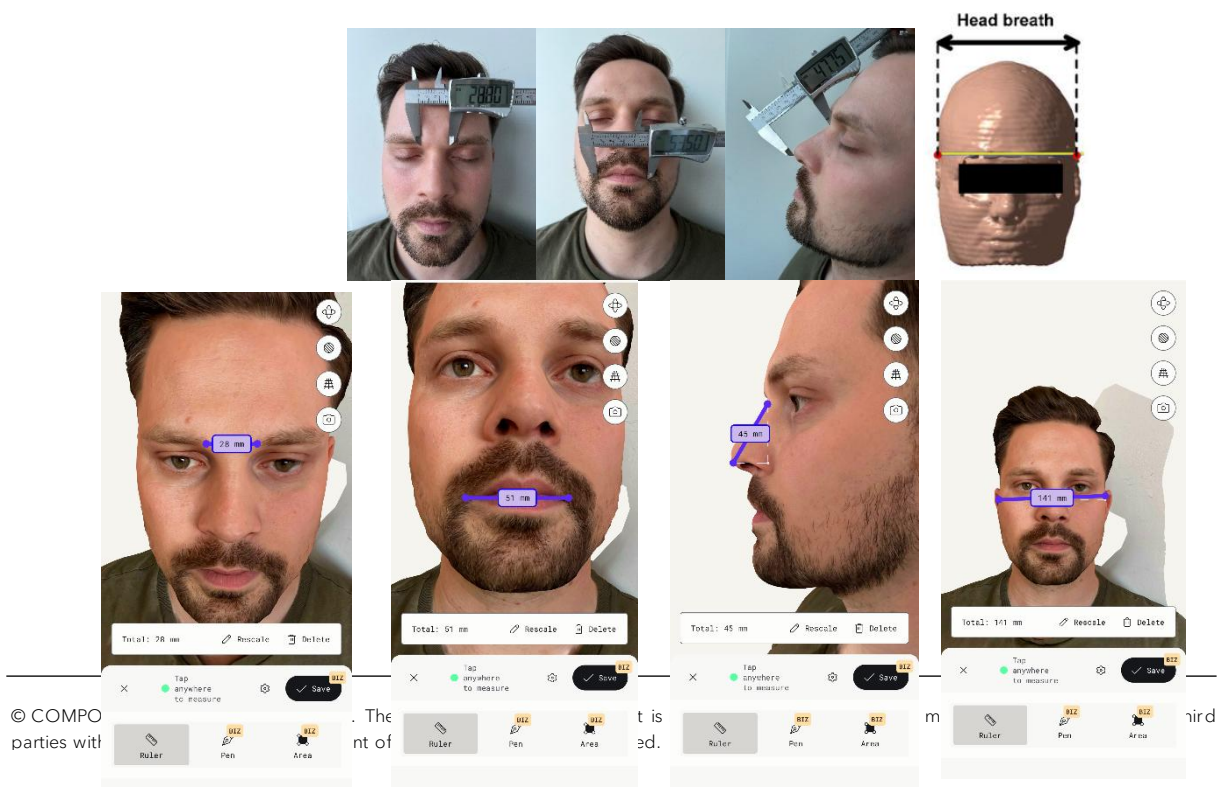

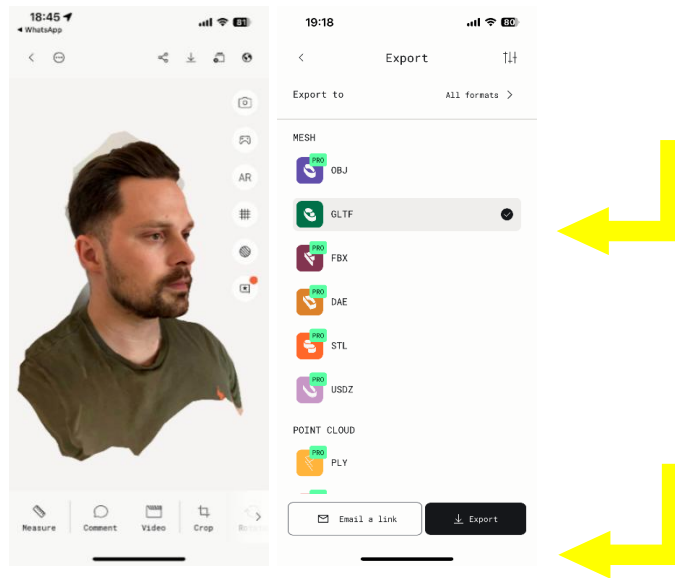

2. Data Protection Notice

Your 3D facial model and captures of manual measurements will be used exclusively to determine the correct standard mask size or to produce a custom-made protective mask. Data will not be shared with third parties and will be processed in accordance with GDPR. You have the right to request deletion of your data at any time.

In Bratislava, 03.02.2026

Adrian VOROS, MSc
CEO & Chief Engineer